

Swirling

In the Woods

Conquillam City, Canada

Envisioned the centre as a "natural escape" for youth, where buildings defined by organic tectonic shapes inspired from the seeds of Douglas Fig found from the forest surroundings. By diversifying the mass and volume, a multi-layered and playful environment was formed to encourage multi-directional communications and connections to spark the creativity among the youth in the rich exploratory space with infinite possibilities. The striking feature is its explorative floating loop meandering through different worlds of passageways and spaces for the youth to discover and create moments of excitement and wonderment along the journey. Ones will be engaged and express themselves through spaces bathed with enticement and fantasy enabling a sense of wonder traveling into a magical gateway into the nature.



Site Plan

1:800



Site Planning

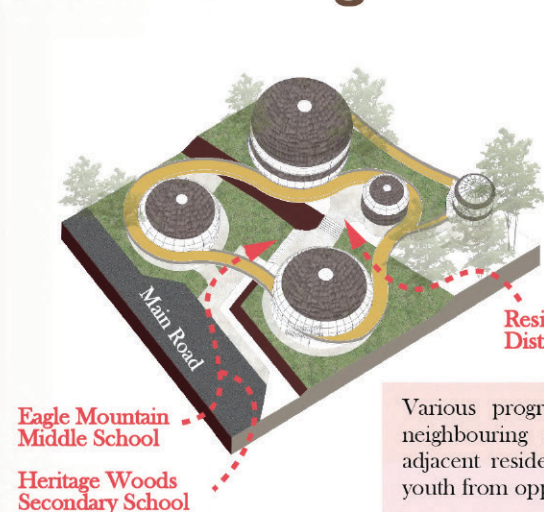

Eagle Mountain Middle School
Heritage Woods Secondary School

Various programme cater for neighbouring site users from adjacent residential district and youth from opposite school

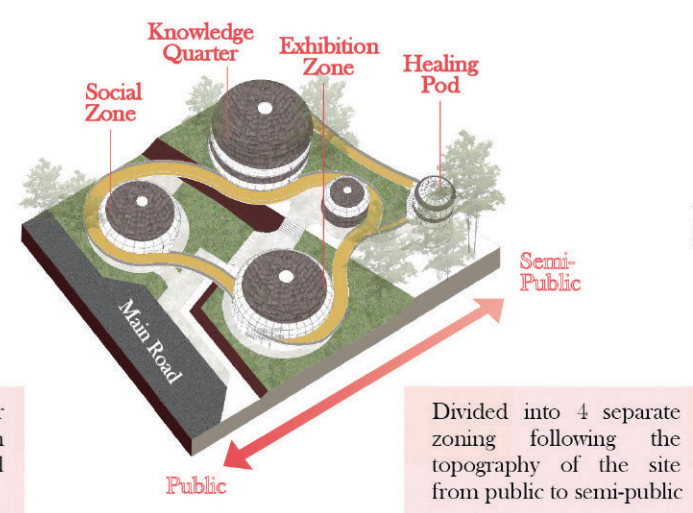

Divided into 4 separate zoning following the topography of the site from public to semi-public

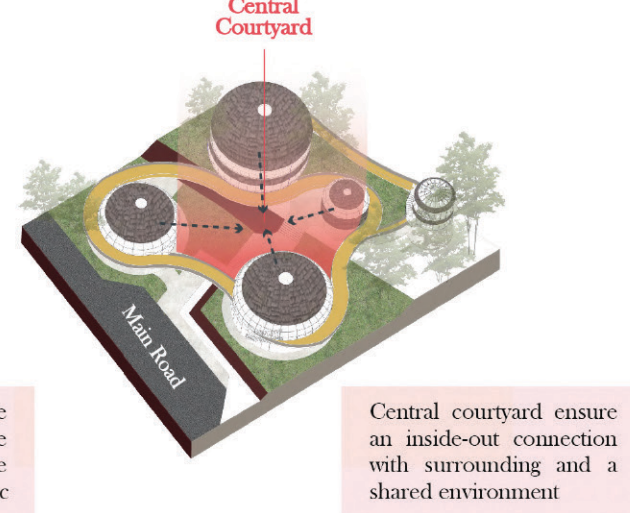

Central courtyard ensure an inside-out connection with surrounding and a shared environment

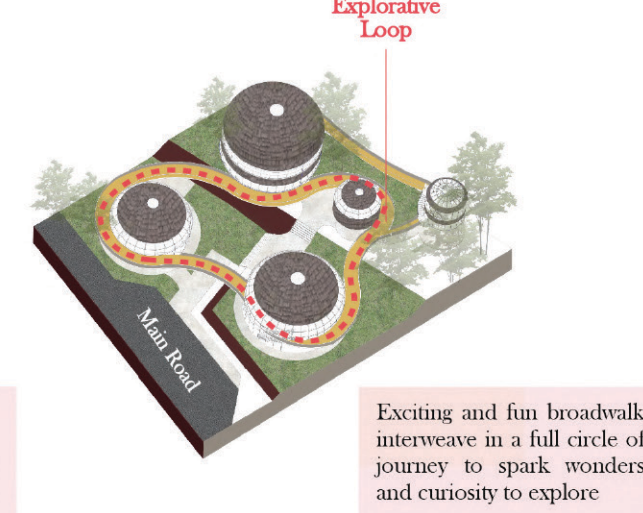

Exciting and fun broadwalk interweave in a full circle of journey to spark wonders and curiosity to explore

Design Inspiration

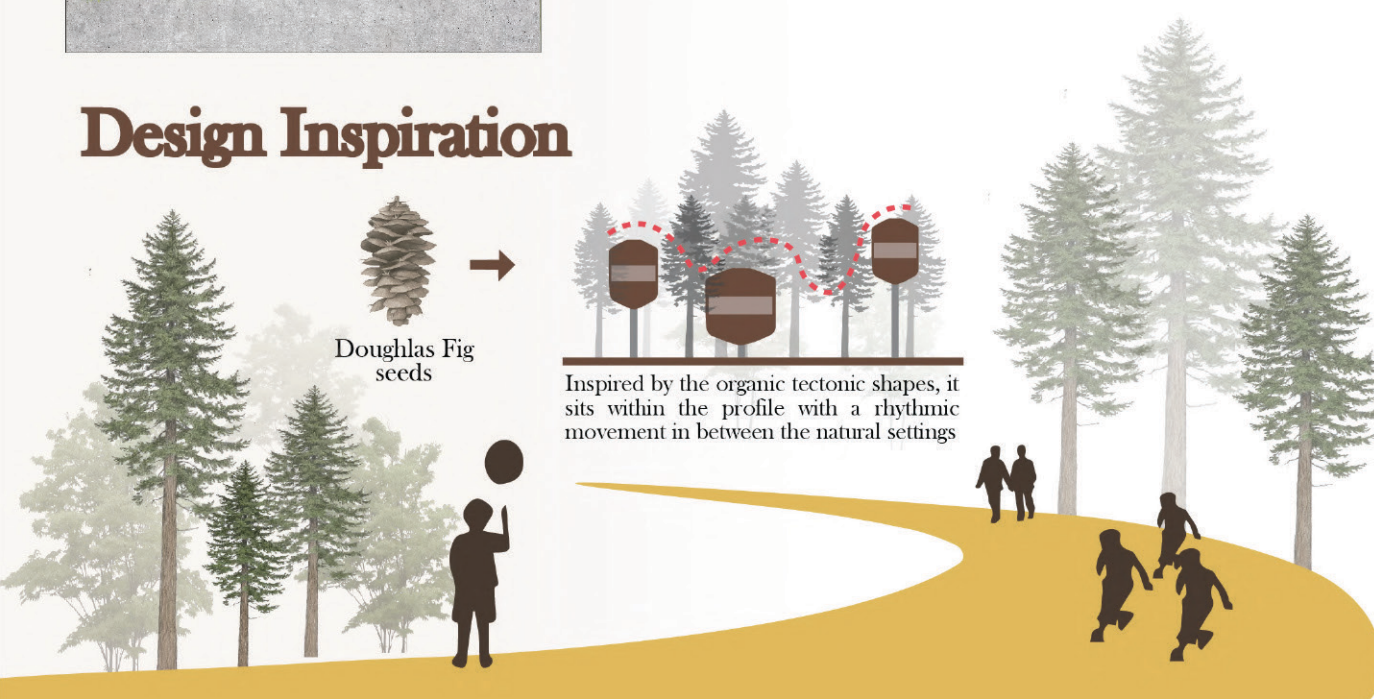

Douglas Fig seeds

Inspired by the organic tectonic shapes, it sits within the profile with a rhythmic movement in between the natural settings

Into the Magical Escape

Knowledge Quarter

Free and flexible space with opened layout available for various type of group activities or a collaborative style of learning

Social Zone

Interactive area provided with library cafe, located near to the public road and entrance catering the immersivity of intimacy between people and nature

Learning? I'm ready!

It's time for sharing!

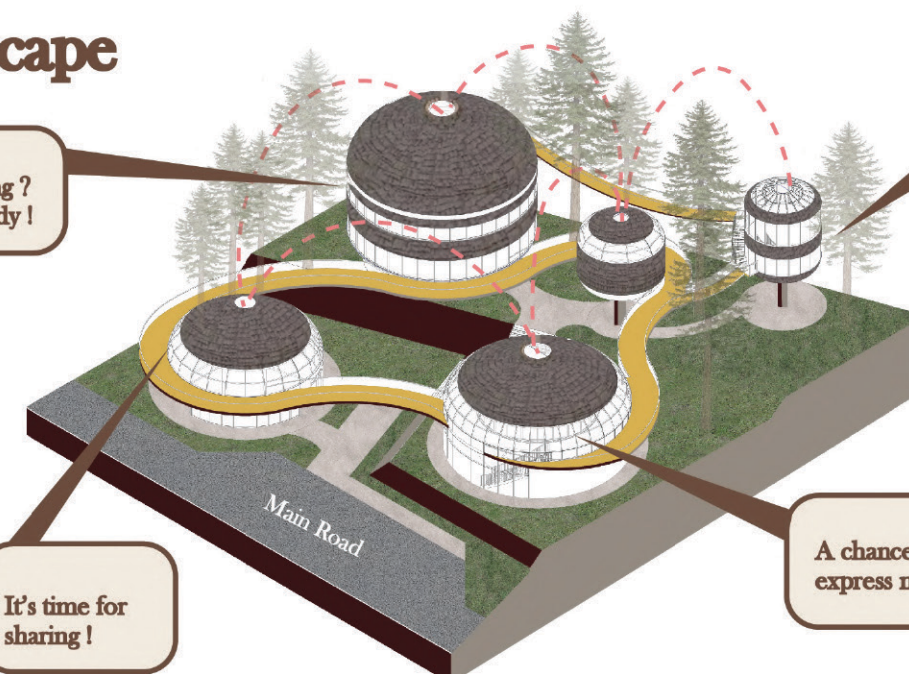

Let's have a break!

Healing Pod

Provide a moment of calm through the connections between youth and nature in the sun glimmering in between the trees

Exhibition Zone

Formal platform to provide opportunities for youth to express their self through their presented work or project

A chance to express myself!

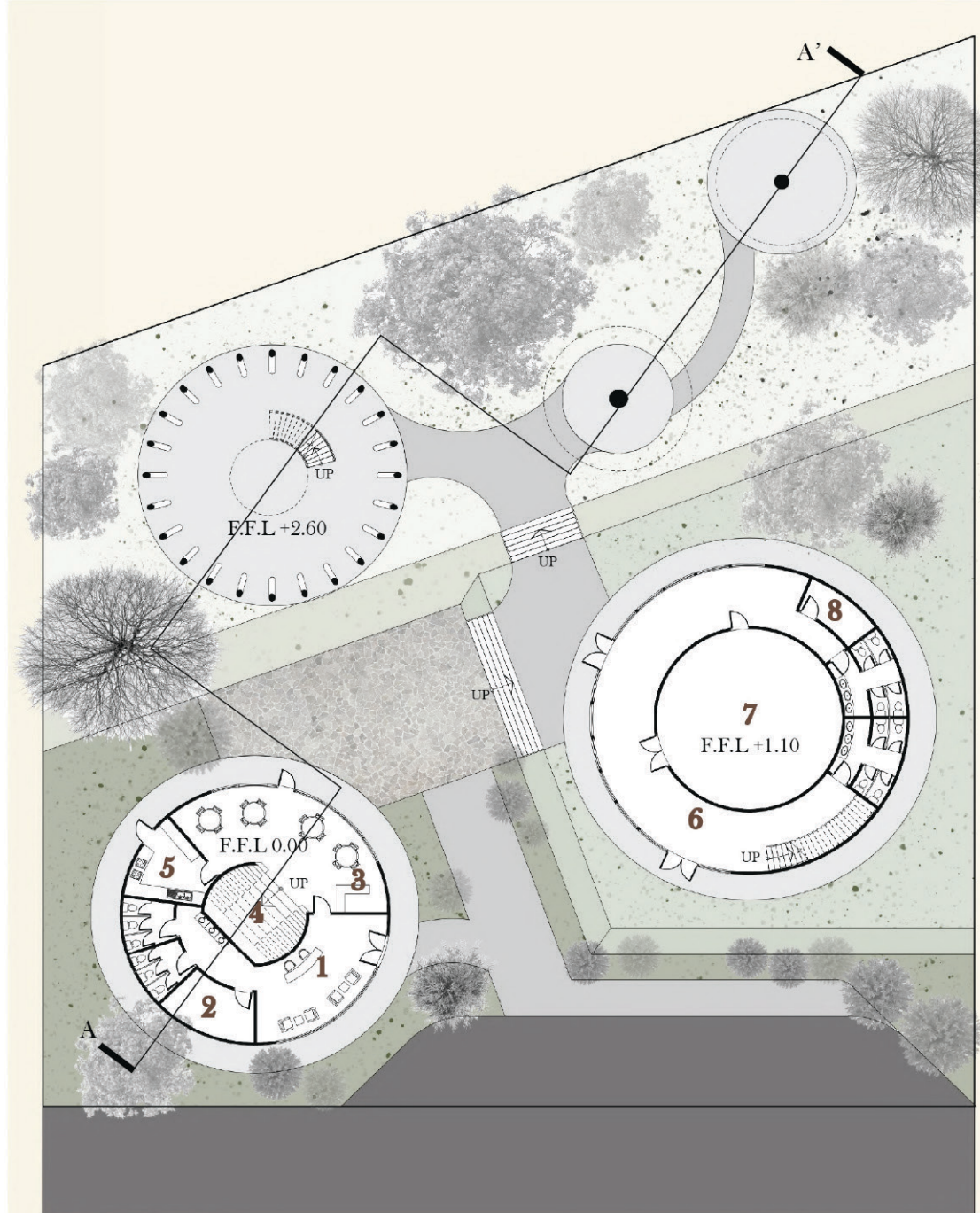

Room Legend

- 1 Lounge
- 2 Admin Office
- 3 Library Cafe
- 4 Social Staircase
- 5 Food preparation area
- 6 Interactive Gallery
- 7 Event space
- 8 Storage

Ground Floor Plan

1:400

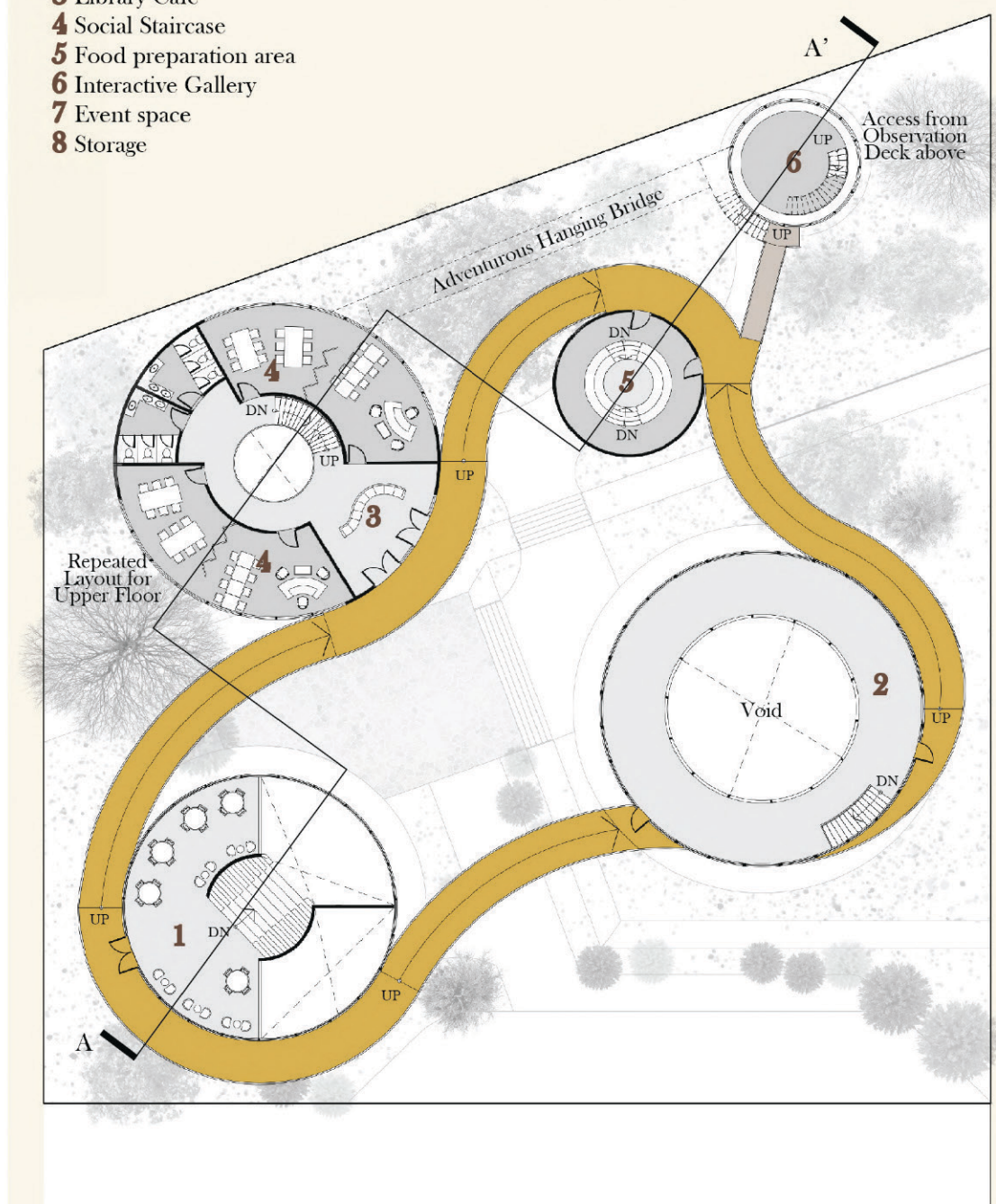

Room Legend

- 1 Library Cafe
- 2 Rooftop Garden
- 3 Informal Sharing Space
- 4 Learning Classroom
- 5 Environmental Education Pod
- 6 Healing Pod

First Floor Plan

1:400

Programmes

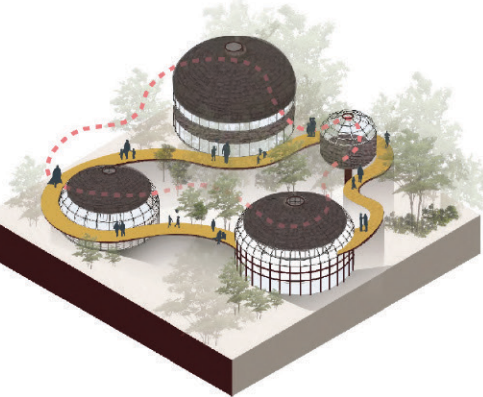

Explorative Loop

Path which enveloping the site offering a wholesome journey interacting with nature to observe the scenery and unwind

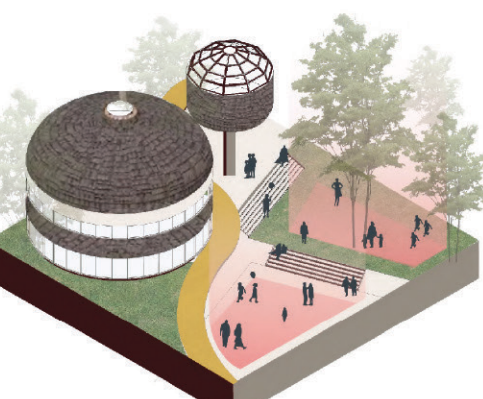

Courtyard

A central social heart connecting various zones with garden promenade accommodate with range of public event or activities



Hanging Bridge

Exciting and fun connection to be explored by the youth while traveling for ease access to different activities and spaces



Social Staircase

An informal interactive platform which prompt spontaneous sharing and gathering point for an open and collaborative learning process

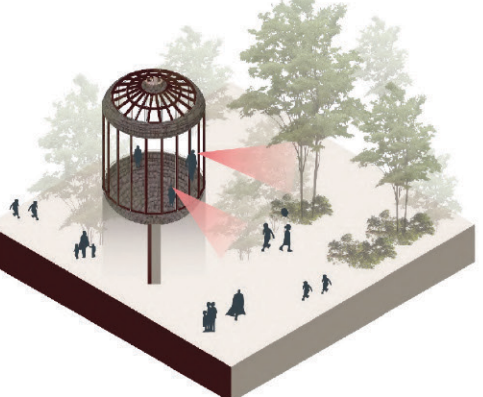

Healing Pod

Provide a moment of calm through the connections between youth and nature in the sun glimmering in between the trees



Section A-A'
1: 300



Combined with the landscape and infinite sky, the surreal environment inspires people to think, reflect and chase endless possibilities.



West Elevation
1: 600

Building Materials



Wood Shingles

Natural weathering of wood shingles as facade creates a textured, rugged appearance, sit beautifully within nature



Stone

Strong and durable natural stone as structural wall supporting the load



East Elevation
1: 600

North Elevation
1: 600



The staircase doubled as a transition space and vertical social condenser, where spontaneous interaction often take place.



The Loop connects independent spaces in unity, making people feel as if they have entered a whole new realm.



In the courtyard, there is nature, world and human life, acting together to form the core of the architecture.